

PROPOSED GROUND FLOOR LAYOUT OF NEW PREMISES FOR NIZAMBAD BRANCH, TG.

AREAS

PLINTH AREA : 1186.27 Sq.Fts
BRANCH CARPET AREA : 1084.45 Sq.Fts,

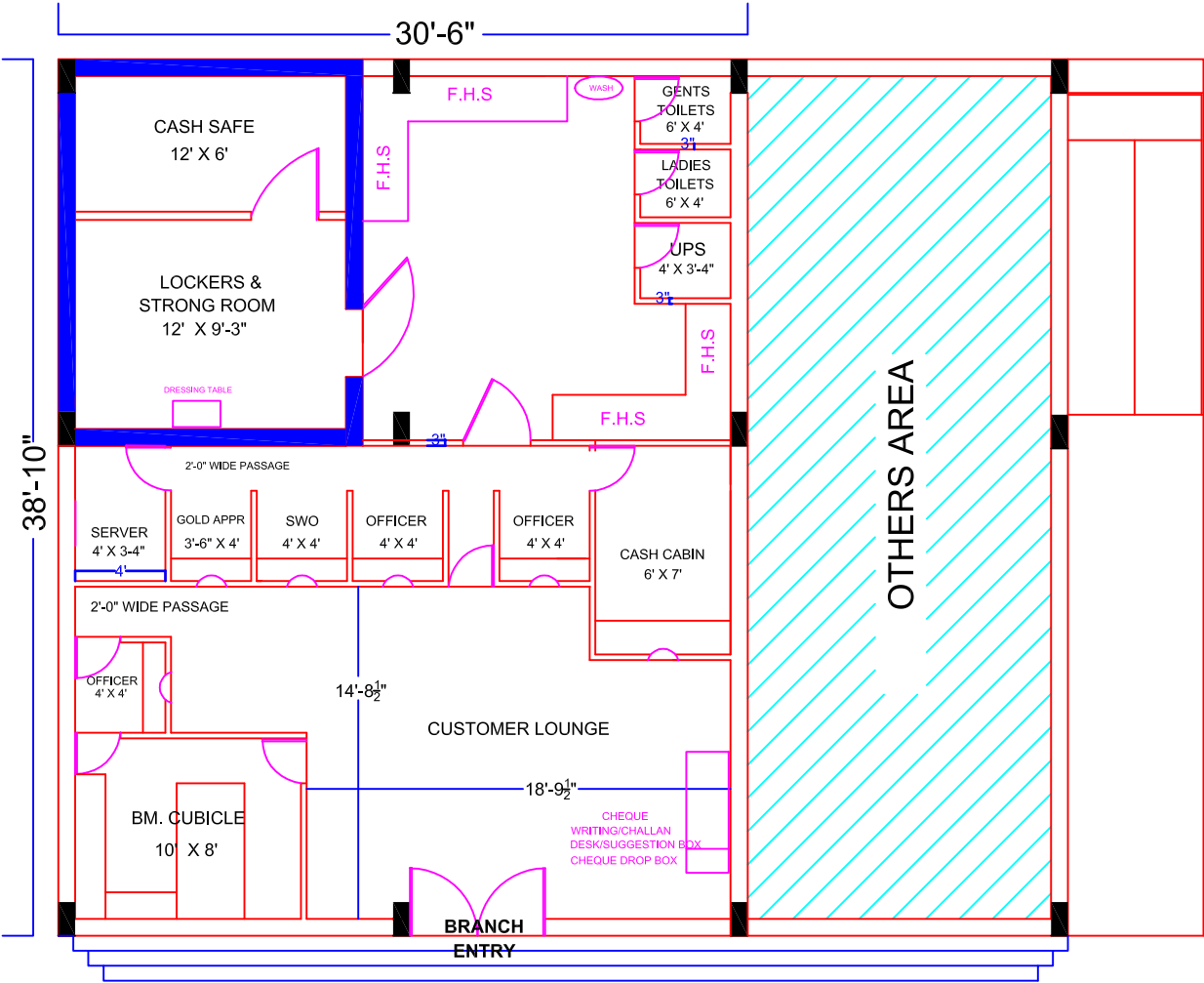
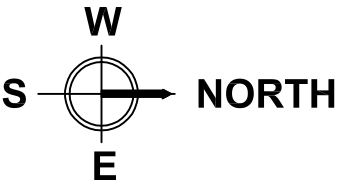

NIZAMBAD TO ARMOOR ROAD